



●縦型チップ 105°C品

●VERTICAL CHIP TYPE 105°C USE

EC-LCシリーズ

JIS C 5101
CE-32

TYPE EC-LC

JIS C 5101
CE-32

■ 特徴

- ・105°C、1000時間保証品
- ・低漏れ電流品

■ FEATURES

- ・It's guaranteed for 105°C as well as 1,000 hours.
- ・Low Leakage Current type

■ 性能/PERFORMANCE SPECIFICATIONS

カテゴリ-温度範囲	CATEGORY TEMPERATURE RANGE	-55°C ~ +105°C			
標準静電容量許容差	STANDARD CAPACITANCE TOLERANCE	±20% (120Hz, 20°C)			
漏れ電流 (最大値)	LEAKAGE CURRENT (MAX.VALUE)	I=0.002CV or 0.5 μA Whichever is greater (after 2 minutes)		C=RATED CAPACITANCE (μF) V=RATED VOLTAGE (V)	
損失角の正接 (最大値) (tan δ)	DISSIPATION FACTOR (MAX.VALUE) (tan δ)	WV	25	50	63
		tan δ	0.16	0.12	0.12
耐久性 105°C, 1000時間 定格電圧印加	ENDURANCE APPLICATION OF RATED VOLTAGE, AT 105°C FOR 1000 hours.	CAPACITANCE CHANGE LESS THAN ±25% OF THE INITIAL MEASURED VALUE DISSIPATION FACTOR: LESS THAN 200% OF THE INITIAL SPECIFIED VALUE LEAKAGE CURRENT: LESS THAN THE INITIAL SPECIFIED VALUE			
低温特性 120Hz +20°Cを基準とする。	LOW TEMPERATURE STABILITY RATIO OF IMPEDANCE AT COLD TO THAT AT 20°C, 120Hz. MAX. VALUE	WV	25	50	63
		-25°C/+20°C	2	2	2
		-55°C/+20°C	3	3	3

■ 寸法図 / DIAGRAM OF DIMENSIONS

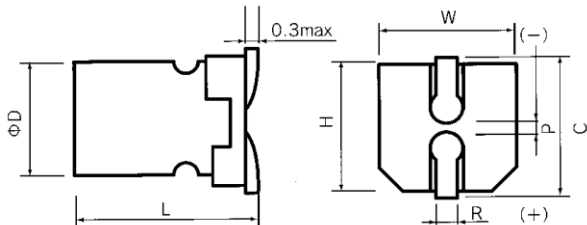

(mm)

D+0.5max	L	W±0.2	H±0.2	C±0.2	R	P
5	5.7±0.3	5.3	5.3	6.0	0.5~0.8	1.5
6.3	5.7±0.3	6.6	6.6	7.3	0.5~0.8	2.0
6.3	7.7±0.3	6.6	6.6	7.3	0.5~0.8	2.0
8	10.5±0.5	8.3	8.3	9.0	0.8~1.1	3.1

■ 寸法表 (φD×L) / SIZE TABLE (φD×L)

Cap. (μF)	25 (1E)		50 (1H)		63 (1J)	
	φD×L (mm)	Ripple (mArms)	φD×L (mm)	Ripple (mArms)	φD×L (mm)	Ripple (mArms)
10	5×5.7	24	6.3×5.7	33	6.3×7.7	58
22	6.3×5.7	41	6.3×7.7	88	6.3×7.7	60
33	6.3×5.7	44	8×10.5	112		
47	6.3×7.7	92	8×10.5	120		
100	6.3×7.7	95				

Ripple Current: 120Hz, 105°C

■ 品番ご指定法 / HOW TO SPECIFY ITEM NUMBER

1H EC-LC 100 M A E57

